

**NOT FOR CONSTRUCTION**  
[CONTRACTOR TO FIELD VERIFY EXISTING  
CONDITIONS PRIOR TO PRICING THIS PLAN]

**PLAN LEGEND**

- EXISTING TO REMAIN
- WALL
  - PARTIAL HEIGHT WALL
  - WINDOW / SIDELIGHT
  - DOOR AND FRAME
- NEW / RELOCATED
- WALL
  - PARTIAL HEIGHT WALL
  - WINDOW / SIDELIGHT
  - BUILT-IN CASEWORK/  
PLUMBING FIXTURE
  - DOOR AND FRAME
    - R = RELOCATED FROM  
DECONSTRUCTION, PAINTED
    - N = NEW TO MATCH EXISTING
    - G = FRAMELESS GLASS SYSTEM
  - PROPOSED EXPOSED  
CEILING AREA
  - PROPOSED SPECIALTY  
CEILING AREA

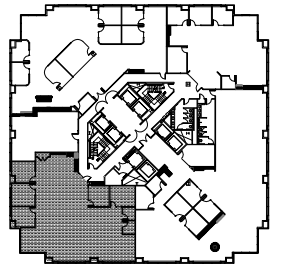

**SUITE 1740**

BMO PLAZA | 17TH FLOOR | 135 N. PENNSYLVANIA | INDIANAPOLIS, IN

4,027 RSF

2025.082  
DATE: 04.25.25  
PROJECT MGR: AS  
SCALE: NTS